

REV.	DESCRIPTION	DRW.	CHK.	APP.	DATE
A	RELEASE				

SPECIFICATIONS

Current Rating:
2 Amp

Voltage Rating:
125V

Insulator resistance:
3000 Megohms Min.

Contact Resistance:
20 m ohms Max.

Dielectric withstanding:
AC 500V/minute

Operating Temperature:
-40° ~ +105°C

Contact Material:
Brass

Insulator Material:
Polyester UL94V-0

Standard Color:
Black

Finish:
Gold, Tin or Duplex plated
Duplex plated:
Gold plated on contact area
Tin on solder area

RoHS Compliant

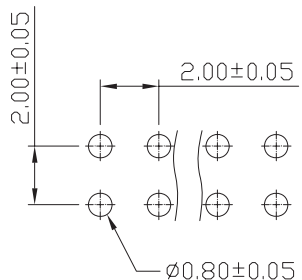
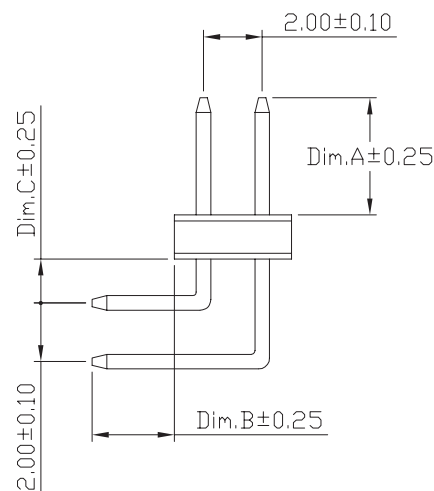
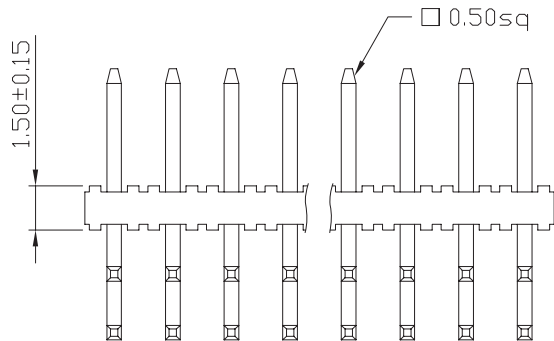
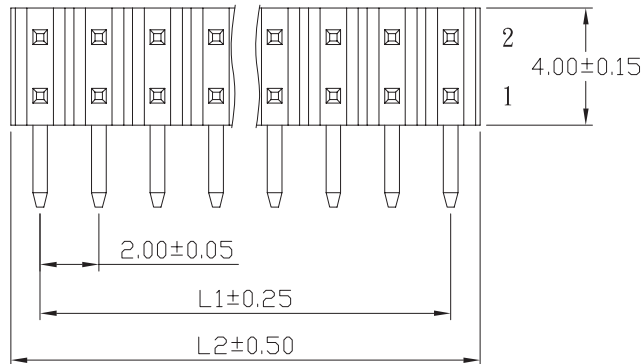

RECOMMENDED P. C. B. LAYOUT

Cir- cuits	Dimension mm	
	L1	L2
2X2	2.00	4.00
2X3	4.00	6.00
2X4	6.00	8.00
2X5	8.00	10.00
2X6	10.00	12.00
2X7	12.00	14.00
2X8	14.00	16.00
2X9	16.00	18.00
2X10	18.00	20.00
2X11	20.00	22.00
2X12	22.00	24.00
2X13	24.00	26.00
2X14	26.00	28.00
2X15	28.00	30.00
2X16	30.00	32.00
2X17	32.00	34.00
2X18	34.00	36.00
2X19	36.00	38.00
2X20	38.00	40.00
2X21	40.00	42.00
2X22	42.00	44.00
2X23	44.00	46.00
2X24	46.00	48.00
2X25	48.00	50.00
2X26	50.00	52.00
2X27	52.00	54.00
2X28	54.00	56.00
2X29	56.00	58.00
2X30	58.00	60.00
2X31	60.00	62.00
2X32	62.00	64.00
2X33	64.00	66.00
2X34	66.00	68.00
2X35	68.00	70.00
2X36	70.00	72.00
2X37	72.00	74.00
2X38	74.00	76.00
2X39	76.00	78.00
2X40	78.00	80.00

成品規格圖				APP.	ANGLES	±3°	SIZE	A4
TITLE	2.00mm Pin Header Right Angle Type			CHK.	LINEAR	0.0 ±0.38	SCALE	4:1
PART NO	PHDR40G2-R					0.00±0.25	SHEET	1/1
DRWNO	202500003			DR.	康濟寶			
UNIT	mm(INCH)	PROJECT	◎ ◻		94.05.31			

gtk **GTK UK LTD.**