

REV.	DESCRIPTION	ECN NO.	DWN.	CHK.	APVD.	DATE

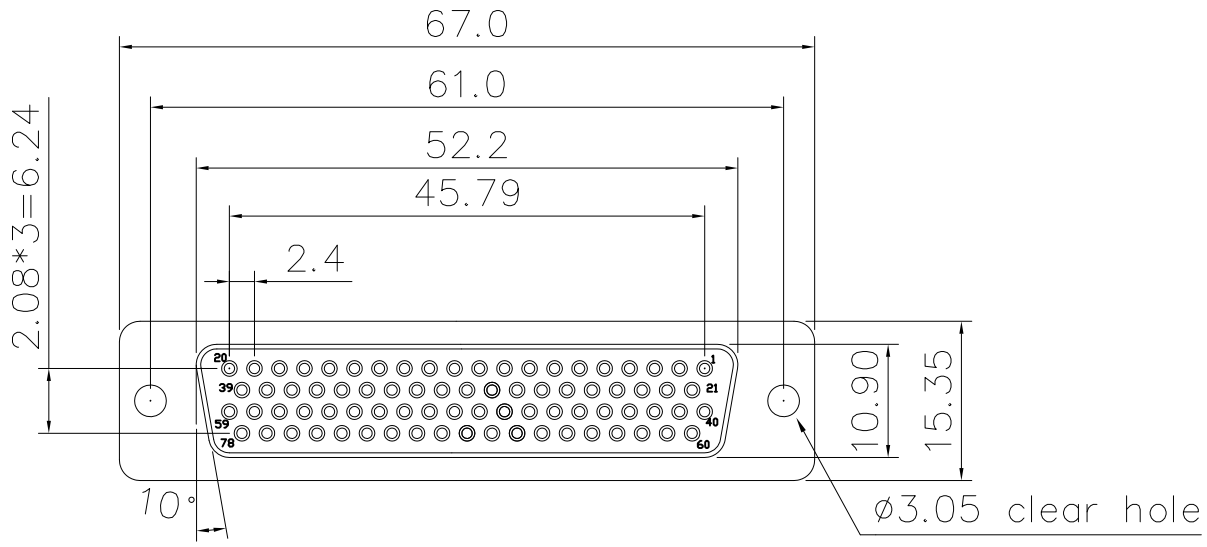

Product Specification

Insulation : Glass-Filled Thermoplastic PBT, UL94V-0
 Contact : Brass
 Shell : Steel, 100u" Tin Over 50u" min Copper
 Clinch Nut : Brass, Nickel Plated
 Screwlock : Brass, Nickel Plated

Electrical

Contact Resistance : 20 milliohms
 Max at 1 AMP DC.
 Insulation Resistance : 1000
 megohms at 500 VDC
 Dielectric Withstanding Voltage :
 500 VAC/rms 60Hz for 1 minute
 Current Rating : 3 AMP
 Voltage Rating : 250 VAC/rms 60Hz

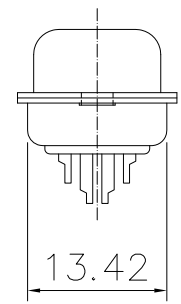
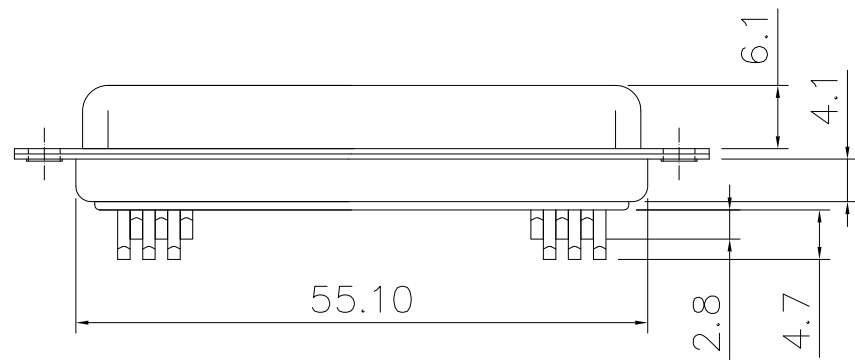

DO NOT SCALE DRAWING

DIMENSIONS: <input type="checkbox"/> mm [INCH] <input type="checkbox"/> INCH [mm] <input checked="" type="checkbox"/> mm ONLY		CAD GENERATED DRAWING, DO NOT MANUALLY UPDATE DRAWN BY AND DATE JACK CHEN 2010-06-08	GTK UK Ltd
UNLESS OTHERWISE SPECIFIED, GENERAL TOLERANCE: DECIMALS ANGLES X: ±0.38 [0.015] X° ±3° .X ±0.25 [0.010] .X° ±1.0° .XX ±0.13 [0.005]			
MATERIAL:		APPROVED BY AND DATE FRANKY CHEN 2010-06-08	TITLE 104 SERIES D-SUB HD SOLDER TYPE
FINISH:		THIRD ANGLE PROJECTION 	DRAWING NO. 104-782XXXXXXX
SCALE: 1 : 1		SIZE: A3	REV.
FILE NO.:			SHEET 1 OF 1